

SERVICE NOTE

MFK2/KLY5: Deep cleaning U/D mechanism

Before you start

The Up / Down mechanism gets dirty after some time of use. It is heavily loaded especially during the high / low temperature measurement, when the number of up / down cycles is significantly greater than during the anisotropy measurement.

The dust accumulate on the inner surface of the plastic tube, which consequently causes creation of the scratches on the inner surface of the tube. All the deposits also increase the friction in the system.

STEP 1

- Switch the device ON and run the software SAFYR7. From upper main menu select *Execute > Auxiliary commands*.
- Move with the holder down and up using buttons in Auxiliary screen. The execution time of "Up" movement must be less than 3.6 sec. If not, clean the Up/Down mechanism following next step.

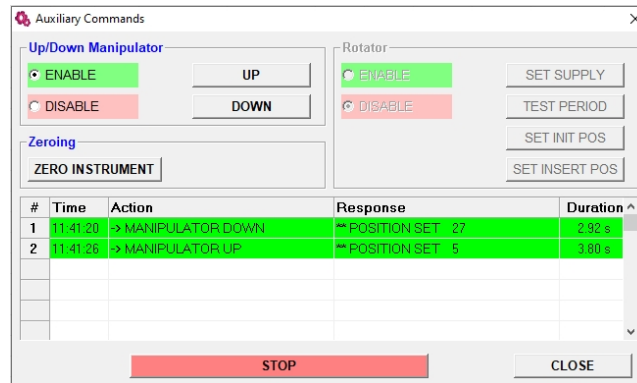

Figure 1: Auxiliary commands

STEP 2

- Move the Up / Down mechanism to „down“ position using the button in Auxiliary screen. Switch the device off, unplug all cables from Pick-up unit.
- Loosen a little bit the screw marked by red circle in Figure 2 and remove the arm of the holder. Use the proper size of screwdriver.



Figure 2: Arm of the holder

- Unscrew the plastic screw using 5mm hex key. Screw is marked by red circle in Fig. 3. Then remove the plastic disc from the tube. You can clean it in warm water with drop of detergent.

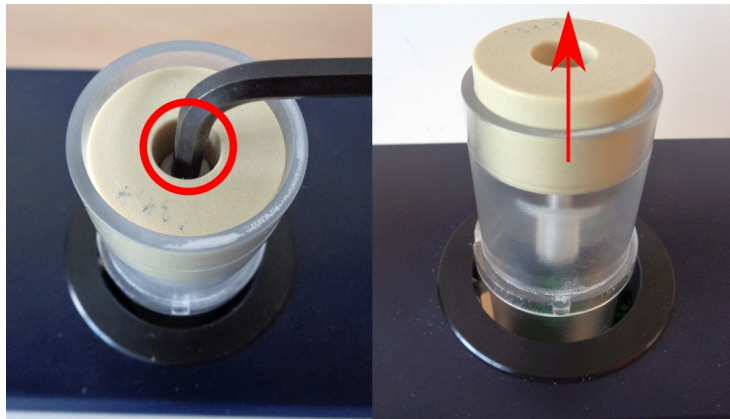

Figure 3: Plastic disk

- Unscrew two screws on the back panel of pick-up unit and remove it(Figure 4).

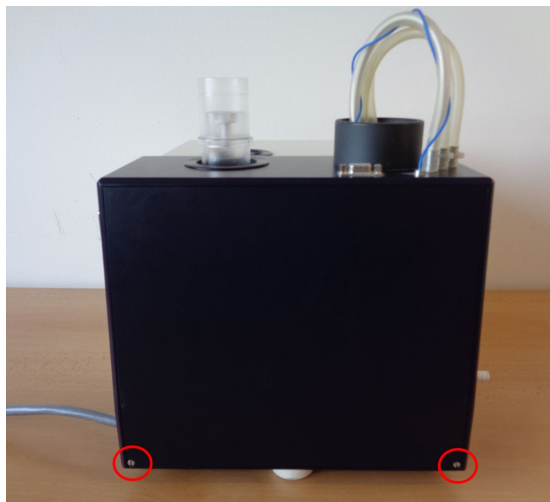

Figure 4: Back panel

- You have access inside, unscrew marked nut in Figure 5

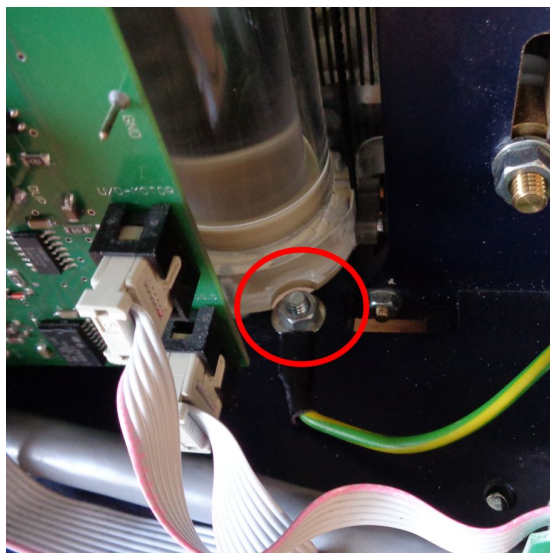

Figure 5: Nut with grounding cable

- Place pick-up unit on the edge of table to get access to screws from bottom. Unscrew three marked screws in Fig. 6 .

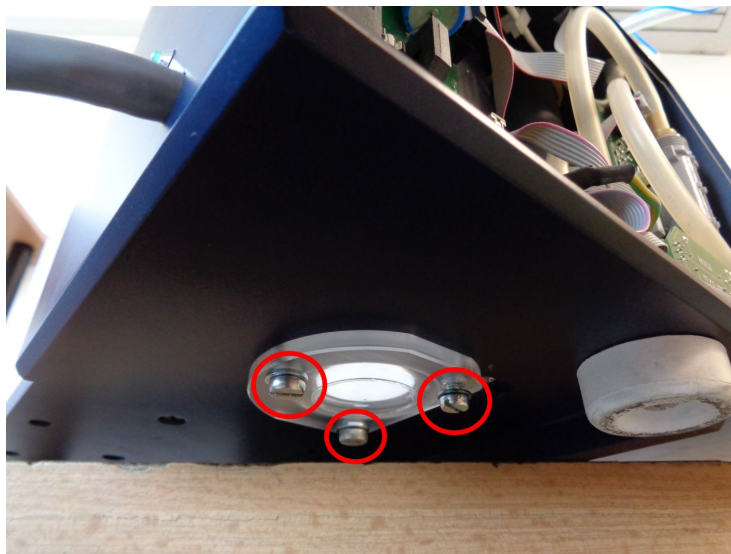

Figure 6: Pick-up unit from bottom

- Now you can slide out the cylinder and clean it in water. Dry it properly before reassembling.
- Tube can be clean with paper towel wound on a screwdriver. Try to clean bottom yellow ring as much as possible.



Figure 7: Cleaning of tube

- Insert cylinder back to tube and fix it with three screws. Marked screw in Figure 8 must be tightened with nut. Do not forget on grounding cable.

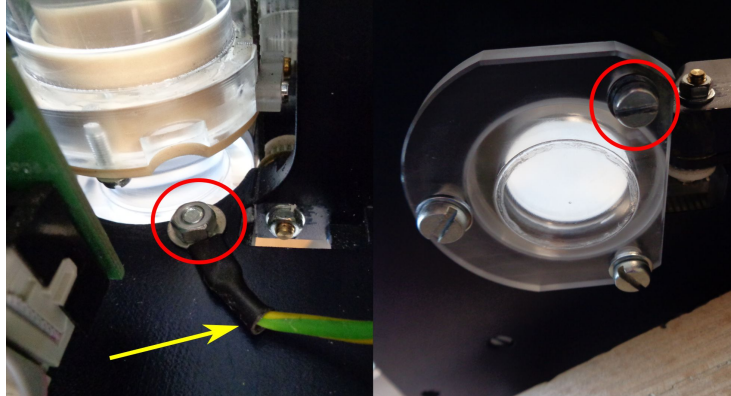

Figure 8

- Install back panel and fix it with two screws. Insert plastic disk on the top of cylinder. Gently tighten the plastic screw. Put arm of holder back. Reverse steps as it is on figures 2, 3, 4.

Thank you for your assistance.